

# SUNSEEKER PREDATOR 82

The **Predator 82** brings together dynamic new design principles to offer more space and comfort than ever.



<b>Length (overall)</b>	24.97m
<b>Beam (max)</b>	6.00
<b>Draft</b>	1.72 m
<b>Displacement</b>	48 300 kg
<b>Engine</b>	Twin MAN 1550 CRM
<b>Cabins</b>	4
<b>Berths</b>	8 + crew
<b>Toilets/Showers</b>	5/5
<b>Fuel Capacity</b>	6000 litres
<b>Water Capacity</b>	1000 litres
<b>Max Speed</b>	45 knots
<b>Cruising Speed</b>	32 knots



The centerpiece has to be the hard-top on the upper deck - a unique rotating glass sunroof adding more light than ever. Performance is entirely down to you, with a choice of twin diesel engines powering either shaft drives or Arneson surface drives. The yacht accommodates up to 8 guests and crew.





**FACILITIES:**

Hydraulic bathing platform

Garage

Specially designed wet bar with icemaker, cool chest, hot and cold water

Ceramic griddle in cockpit

Hydraulic bow thruster

Hydraulic stern thruster

Flat screen television in all cabins (excluding crew)

Surround sound system for Deck Saloon and Aft Master Stateroom

Teak Cockpit, bathing platform and steps

Teak side decks

Opening hardtop roof

All cabin air conditioning

Crew quarters





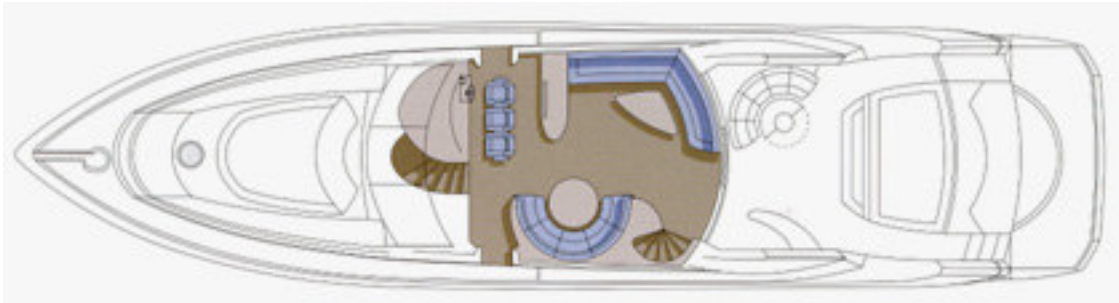
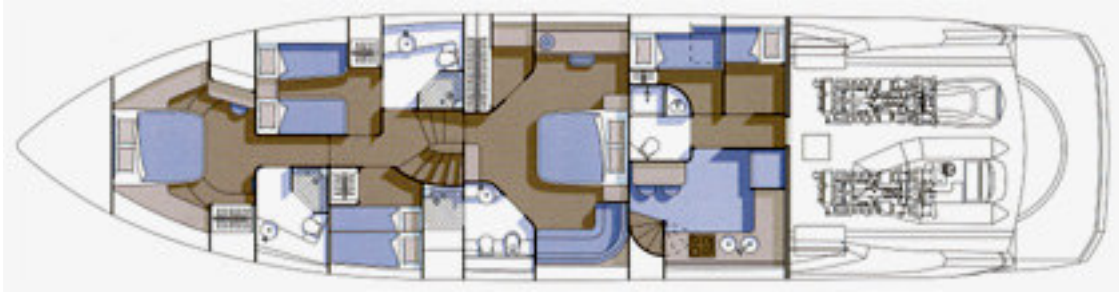

---

**Welcome on board !**